

STIEBEL ELTRON



3in1 Tap

A sleek 3 in 1 mixer that delivers hot, cold, and boiling water, available in four stylish colours.



Design-Kollektion

3 IN 1 TAPS

Stylish Convenience at Your Fingertips

Elevate your kitchen experience with our sleek 3in1 taps, offering hot, cold, and boiling water in four stunning colors. Designed to make a statement in any home, these taps provide reliable access to all your water needs while enhancing your kitchen's aesthetic. For added safety, the built-in push & turn mechanism ensures peace of mind.

Product features

- › Elegant design available in four colours
- › Efficient hot, cold, and boiling water delivery
- › Easy installation with seamless integration
- › Eco-friendly operation, reducing energy consumption

Specifications	3in1 Tap
WELS Rating	6 star
Flow Rate - Hot and Cold	4.5 L/min
Flow Rate - Boiling	2.5 L/min
Outlet Reach	220 mm
Tap Hole Diameter	35 mm
Minimum Temperature	1°C
Maximum Temperature	95°C
Minimum Pressure	150 kPa
Maximum Pressure	500 kPa

Dimensions

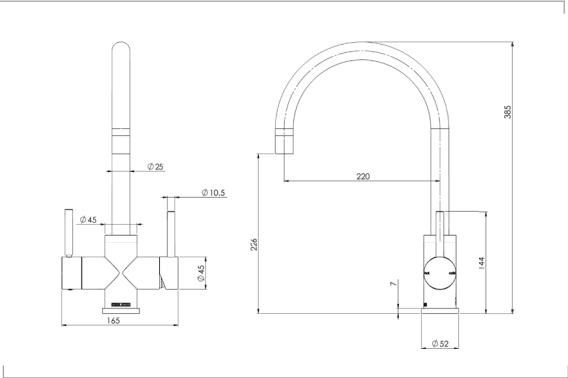

STIEBEL ELTRON is committed to our policy of continual improvement, some features may have subsequently been changed or even removed. Our advisors will be happy to consult with you regarding the currently applicable equipment features. The images used in this data sheet are for reference only.



Brushed Nickel



Chrome



Brushed Gold



Matte Black